

DocuPrint P225 d / P265 dw / M225 dw / M225 z / M265 z  
A4 Monochrome Laser  
Printers



# DocuPrint P225 d / P265 dw / M225 dw / M225 z / M265 z A4 Monochrome Printers

Delivering performance and productivity  
with clever connectivity

# Powerful, efficient performers

The Fuji Xerox DocuPrint P225 d / P265 dw / M225 dw / M225 z / M265 z are the perfect solution for personal use or small workgroups requiring high quality, efficient monochrome printing together with flexible connectivity capabilities.

## Performance and reliability

- **Speed and quality.** With a print resolution of up to 2400 x 600 dpi and printing speeds of 26 ppm across the 225 Series, and 30 ppm for the 265 Series, they deliver quality print results fast.
- **All-in-one functionality.** Multifunction models allow you to print, copy, scan and fax\* in an efficient, low cost device giving you maximum productivity.
- **Clever features for reliable operation.** Fuji Xerox is renowned for reliable printing. The DocuPrint P225 d / P265 dw / M225 dw / M225 z / M265 z are no exception – with simple engineering and clever new ideas designed for trouble-free printing.

\*Only available on DocuPrint M225 z / M265 z

## Affordable, efficient printing

- **Low cost hardware is only half of the story.** Thanks to the separate toner and drum cartridge, you will only ever have to replace one component at a time. This results in maximum use of each component, longer operating times and cost savings.
- **Save toner – save cost.** Toner save mode extends the life of the toner cartridge by varying the density of toner that is printed on a page.
- **Use less paper and toner.** The built in N-UP print feature gives users the ability to save on paper and toner by printing multiple pages on a single sheet of paper. This also reduces the overall cost of printing.



## Easily connect and print via your iOS or Android devices

### AirPrint and Google Cloud Print Ready



AirPrint™ and Google Cloud Print™ enables you to print directly from your mobile device without the need to download mobile apps or to install print drivers.



### Wi-Fi Direct

The DocuPrint P265 dw / M225 dw / M225 z / M265 z are Wi-Fi Direct™ certified, allowing devices to connect and print easily without requiring a wireless access point.



### Print Utility



Whether it's an iOS or Android device, the Fuji Xerox Print Utility puts mobile printing at your fingertips. Print stored photo albums, web pages or shoot and print on the go from your iOS or Android device.

**Fuji Xerox Print Utility** can be easily downloaded from the App Store for iOS and Play Store for Android devices.



**Print from anywhere** Google Cloud Print allows you to connect your printers to the web, so you can make your home and work printers available to you from the applications you use every day, from wherever you are.

DocuPrint M225 z  
4-in-1 Wireless  
Multifunction Laser Printer



DocuPrint P225 d  
Network Laser Printer



DocuPrint P265 dw  
Wireless Laser Printer



DocuPrint M225 dw  
3-in-1 Wireless Multifunction Laser Printer



DocuPrint M225 z  
4-in-1 Wireless Multifunction Laser Printer



DocuPrint M265 z  
4-in-1 Wireless Multifunction Laser Printer  
with single pass Duplex Automatic Document  
Feeder and 2.7" colour touch screen

## Smart features increase productivity

### 2.7" Colour Touch Screen



The 2.7" colour touch screen available on the DocuPrint M265 z provides a clear, simple user interface that makes walk up functions easy to access.

### Duplex printing as standard

Enjoy increased productivity and cost savings with Duplex printing as standard across the entire printer lineup.

The DocuPrint M265 z also features a single pass Duplex Automatic Document Feeder (DADF) supporting duplex scanning and copying, delivering efficiency and productivity gains to any workspace.

### Clever ID Card Copying\*

The easy-to-use ID card copy feature allows you to copy both sides of the card onto the same side of the paper. Simply place an ID card both face up & down on the copier surface, pressing the start button each time. There is no need to change the position of the cards when copying the other side, as the feature automatically adjusts this for you.

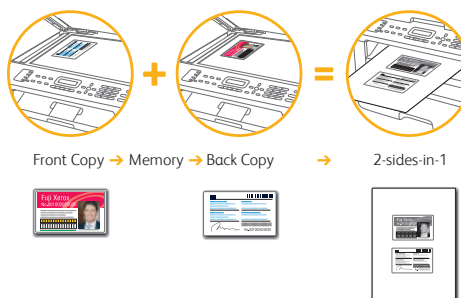

\*Available on multifunction models

# DocuPrint P225 d / P265 dw / M225 dw / M225 z / M265 z Specifications

Product Name	DocuPrint P225 d	DocuPrint P265 dw	DocuPrint M225 dw	DocuPrint M225 z	DocuPrint M265 z
Function	A4 monochrome printer		A4 monochrome MFP		
Print Function					
Print Speed (A4)	Up to 26 ppm <sup>1</sup>	Up to 30 ppm <sup>1</sup>	Up to 26 ppm <sup>1</sup>	Up to 26 ppm <sup>1</sup>	Up to 30 ppm <sup>1</sup>
Print Resolution	Up to HQ1200 technology (2400 x 600 dpi quality)				
First-page-out Time (A4 SEF) (from ready mode)	8.5 second or less				
Warm-up Time	9 seconds or less (from sleep mode)				
Memory	32MB	32 MB	64 MB	64MB	64 MB
Processor	266 MHz				
PDL	PCL6, Host-Based	PCL6, Host-Based	PCL6, Host-Based	PCL6, Host-Based	PCL6, Postscript®3™ Emulation, Host-Based
Colour Touchscreen	—	—	—	—	2.7" Colour Touchscreen
Connectivity	10 Base-T/100Base-TX Ethernet USB2.0 Hi-Speed	Wireless, 10 Base-T/100Base-TX Ethernet, USB2.0 Hi-Speed			
Network protocol for models with network function	IPv4 : ARP, RARP, BOOTP, DHCP, APIPA(Auto IP), WINS/NetBIOS name resolution, DNS resolver, mDNS, LLMNR responder, LPR/LPD, Custom Raw Port/Port 9100, IPP, FTP Server, SNMPv1/v2c/v3, HTTP Server, TFTP Client and Server, SMTP Client, ICMP, Web Services (Print) IPv6 : NDP, RA, DNS Resolver, mDNS, LLMNR responder, LPR/LPD, Custom Raw Port/Port 9100, IPP, FTP Server, SNMPv1/v2c/v3, HTTP Server, TFTP Client and Server, SMTP Client, ICMPv6, Web Services (Print)				
Mobile Print	AirPrint, Google Cloud Print, FX Print Utility for iOS and Android				
Supported Operating System	Windows Vista®, Windows® 7, Windows® 8, Windows® 8.1, Windows Server 2003, Windows Server 2003 x64 Edition, Windows Server 2008, Windows Server 2008 R2, Windows Server 2012, Windows Server 2012 R2®, Mac OS X v. 10.7.5, 10.8.x, 10.9.x <sup>3</sup>				
Duplex Printing	Automatic				
Input Paper Size (Paper Tray)	A4 SEF, Letter SEF, A5 SEF/LEF, A6 SEF, Executive SEF, Folio (8.5" x 13") SEF, Legal SEF, 16K(China only), 210x270mm (Taiwan only)				
Media Input Capacity (Paper Tray)	250 sheets 80gsm				
Media Input Capacity (manual feed slot)	1 sheet				
Input Paper Size (Manual Feed slot)	Width 76.2–216 mm, Length 127–355.6mm				
Media Output Capacity	100 sheets 80gsm (Face down), 1 sheet (Face up with rear cover open)				
Media Types (Main Tray, or Duplex)	Plain paper, Recycled paper				
Media Types (Manual Feed slot)	Plain paper, Thin Paper, Thick Paper, Recycled paper, label, envelope, bond paper				
Input Paper Weight (Paper Tray)	60 to 105 gsm				
Input Paper Weight (Manual Feed slot)	60 to 163 gsm				
Automatic Document Feeder	—	—	Up to 35 sheets (64-90 gsm)		
Single pass Duplex Automatic Document Feeder	—				
Monthly Maximum Duty Cycle	10K pages				Yes
Machine Life	50K page (Duplex 25k page) or 5 years				
Print Features	Toner Save Mode, N-up(2,4,9,16, or 25) <sup>4</sup> , Poster <sup>2</sup> (4,9,16,25), Header/Footer <sup>2</sup> (time & date and/or user ID), Watermarks <sup>5</sup> , manual duplex printing <sup>2</sup> , manual booklet printing <sup>5</sup>				
Dimensions (WxDxH)	356 x 360 x 186 mm	409 x 398.5 x 316.5 mm	409 x 398.5 x 316.5 mm	409 x 398.5 x 316.5 mm	409 x 398.5 x 316.5 mm
Weight (without supplies)	5.9 kg	10.7 kg	11.1 kg	11.1 kg	11.5 kg
Operating Environment Temperature	Storage: 0° C to 40° C, Operating: 10° C to 32.5° C				
Humidity	Operating Environment: 20% to 80% RH (without condensation)				
Acoustics: Sound Pressure level	Printing: 50 dB(A)	Printing: 51 dB(A)	Printing: 50 dB(A)	Printing: 50 dB(A)	Printing: 51 dB(A)
Electrical Power	220–240 VAC, 50/60 Hz				
Power consumption <sup>10</sup>	Ready/Standby: 58W ENERGY STAR® qualified	Ready/Standby: 58W ENERGY STAR® qualified	Ready/Standby: 60W ENERGY STAR® qualified	Ready/Standby: 60W ENERGY STAR® qualified	Ready/Standby: 60W ENERGY STAR® qualified
TEC value	1.0 k Wh/w	1.2 k Wh/w	1.2 k Wh/w	1.2 k Wh/w	1.4 k Wh/w
Wireless Specification					
Wireless LAN	—	IEEE 802.11b/g/n (Infrastructure/Ad-hoc Mode) IEEE 802.11g/n (Wi-Fi Direct™)			
Wireless Network Security	—	WEP 64/128 bit, WPA-PSK(TKIP/AES), WPA2-PSK(AES)			
Network security (Wireless)	—	SMTP-AUTH, SNMP v3			
Wireless Certification	—	Wi-Fi Certification Mark License (WPA/WPA2-Personal), Wi-Fi Protected Setup (WPS) Identifier Mark Licensee, AOSS Logo, Wi-Fi CERTIFIED Wi-Fi Direct			
Copy Function					
Copy Speed (A4)	—	—	Up to 26 cpm <sup>1</sup>	Up to 26 cpm <sup>1</sup>	Up to 30 cpm <sup>1</sup>
Copy Resolution	—	—	Up to 600 x 600 dpi	Up to 600 x 600 dpi	Up to 600 x 600 dpi
First-copy-out Time	—	—	Flat Bed :10 seconds or less; ADF : 11 seconds or less	Flat Bed :10 seconds or less; ADF : 11 seconds or less	Flat Bed :10 seconds or less; ADF : 11 seconds or less
Reduction / Enlargement	—	—	25 - 400% in 1% increments	25 - 400% in 1% increments	25 - 400% in 1% increments
Multi-Copy	—	—	Up to 99	Up to 99	Up to 99
Copy Feature	—	—	ID Card Copy, N in 1 copying (N=2,4), sort(up to 99 pages)	ID Card Copy, N in 1 copying (N=2,4), sort(up to 99 pages)	ID Card Copy, N in 1 copying (N=2,4), sort(up to 99 pages)
Automatic 2-sided copy	—	—	—	—	Standard
Scan Function					
Type	—	—	—	Colour CIS	Standard
Automatic 2-sided scan	—	—	—	—	Standard
Scanning Resolution	—	—	Optical : (Scanner Glass) up to 600 x 1200 dpi (mono), 600x2400 dpi (colour) Enhanced: up to 19,200 x 19,200 dpi	Optical : (ADF) up to 600 x 600 dpi (mono/colour) Colour 24 bit, Mono 8bit Gray Scale	Optical : (ADF) up to 600 x 600 dpi (mono/colour) Colour 24 bit, Mono 8bit Gray Scale
Scan Depth	—	—	Platen: max 215.9mm x 300mm	Platen: max 215.9mm x 300mm	Platen: max 215.9mm x 300mm
Document Size	—	—	ADF: max Width 147.3 – 215.9mm x Length 147.3 – 355.6mm	ADF: max Width 147.3 – 215.9mm x Length 147.3 – 355.6mm	ADF: max Width 147.3 – 215.9mm x Length 147.3 – 355.6mm
Scan Destinations	—	—	Scan to PC and application (Email, Image, File) by ControlCenter utility	Scan to PC and application (Email, Image, File) by ControlCenter utility	Scan to PC and application (Email, Image, File) by ControlCenter utility
Supported Driver	—	—	Windows®: TWAIN, WIA for Windows Vista®/Windows® 7/Windows® 8 /Windows® 8.1 Mac: TWAIN, ICA for OS 10.7.5/10.8.x/10.9.x	Windows®: TWAIN, WIA for Windows Vista®/Windows® 7/Windows® 8 /Windows® 8.1 Mac: TWAIN, ICA for OS 10.7.5/10.8.x/10.9.x	Windows®: TWAIN, WIA for Windows Vista®/Windows® 7/Windows® 8 /Windows® 8.1 Mac: TWAIN, ICA for OS 10.7.5/10.8.x/10.9.x
Fax Function					
Compatibility	—	—	—	ITU-T Super G3	ITU-T Super G3
Communication System	—	—	—	PSTN	PSTN
Modem Speed	—	—	—	33.6 Kbps	33.6 Kbps
Memory Transmission	—	—	—	Up to 500 pages <sup>7</sup>	Up to 500 pages <sup>7</sup>
Out-of-paper reception	—	—	—	Up to 500 pages <sup>7</sup>	Up to 500 pages <sup>7</sup>
Fax Resolution	—	—	—	Superfine 8dot/mm x 15.4line/mm	Superfine 8dot/mm x 15.4line/mm
Speed Dials	—	—	—	Up to 200 locations	Up to 200 locations
Broadcasting	—	—	—	Up to 258 locations	Up to 258 locations
Fax Features	—	—	—	PC Fax Send and Receive <sup>5</sup>	PC Fax Send and Receive <sup>5</sup>
Handset	—	—	—	—	—
Warranty	Please check with your Fuji Xerox Printers reseller for more information				
Consumables					
Shipped consumables (approx.)	1,200 <sup>8</sup> pages toner (225 Series) / 2,600 <sup>8</sup> pages toner (265 Series) and 12,000 <sup>9</sup> pages drum				
Standard Capacity Toner cartridge (approx.) <sup>8</sup>	CT202329 (1,200 pages)				
High Capacity Toner cartridge (approx.) <sup>8</sup>	CT202330 (2,600 pages)				
Drum Cartridge (approx.) <sup>9</sup>	CT351055 (12,000 pages)				

<sup>1</sup> Print/copy speed may decrease due to factors such as paper type, paper size, and printing conditions. <sup>2</sup> Measured diagonally. <sup>3</sup> Mac drivers are available by web download. <sup>4</sup> N-up for Mac (2,4,6,9, or 16). <sup>5</sup> Windows Only. <sup>6</sup> Max 1200 x 1200 dpi scanning with WIS (Windows Image Acquisition) driver in Windows Vista, Windows 7 and Windows 8. <sup>7</sup> ITU-T Test Chart, Standard resolution. <sup>8</sup> Declared yield in accordance with ISO/IEC 19752. Yield will vary based on image area coverage and print mode. <sup>9</sup> Drum yield may vary by the type of use. <sup>10</sup> Measured when the machine is connected to the USB interface. This product has been tested and found to comply with the Class 1 Laser Equipment requirements defined by the international standard IEC60825-1:2007 and has no light exposure hazard. The product has no hazardous light emission as it features light protection components and covers to shut in all light beam during operation and maintenance. Internal Laser radiation. Wave length: 770 - 800 nm. Output: 25 mW max. Laser Class: Class 3B

**Reproduction Prohibitions** Please note that reproduction of the following is prohibited by law:  
Domestic and foreign currencies, government-issued securities, and national bonds and local bond certificates. Unused postage stamps, post cards, etc. Certificate stamps stipulated by law. Reproducing works forming the subject matter of copyright (literary works, musical works, paintings, engravings, maps, cinematographic works, drawings, photographic works, etc.) is not permitted unless the reproduction is for the purpose of personal use, family use or other similar uses within a limited circle.



**For Your Safety**  
Before using the product, read the Instruction Manual carefully for proper use. Use the product with the power source and voltage specified. Be sure to establish ground connection. Otherwise, electronic shock may result in the case of a failure or short circuit.

For more information or detailed product specification, please call or visit us at

**Fuji Xerox Asia Pacific Pte Ltd**

80 Anson Road #37-00 Fuji Xerox Towers Singapore 079907

Tel. +65-6766-8888

<http://www.fxap.com.sg/>

Xerox, Xerox and Design, as well as Fuji Xerox and Design are registered trademarks or trademarks of Xerox Corporation in Japan and / or other countries and are used under license.



The information is as of November 2014. MARS4365